

# Pro-Lift®

# Roller Chair Creeper Seat

## Operating Instructions & Parts Manual

**Model**  
**C-9300**

**Capacity**  
**300 lbs.**



*This is the safety alert symbol. It is used to alert you to potential personal injury hazards. Obey all safety messages that follow this symbol to avoid possible injury or property damage.*

**⚠ WARNING: Cancer and Reproductive Harm.**  
**[www.P65Warnings.ca.gov](http://www.P65Warnings.ca.gov)**

SFA Companies, Inc.  
10939 N. Pomona Ave.  
Kansas City, MO 64153  
Phone (816)891-6390, Fax (816)891-6599

Printed in China  
C-9300-M0\_092021

## SAFETY AND GENERAL INFORMATION

For your safety, read, understand, and follow the information provided with and on this folding creeper. The owner and operator shall have an understanding of this product and safe operating procedures before attempting to use. The owner and operator shall be aware that use of this product may require special skills and knowledge. Instructions and safety information shall be conveyed in the operator's native language before use of this product is authorized. Make certain that the operator thoroughly understands the inherent dangers associated with the use and misuse of the product. If any doubt exists as to the safe and proper use of this product, remove from service immediately.

**Inspect before each use.** Do not use if there are broken, bent, cracked or damaged parts (including labels). Any folding creeper that appears damaged in any way, or operates abnormally shall be removed from service immediately. If the folding creeper has been subjected to a shock load (a

load dropped suddenly, unexpectedly upon it), immediately discontinue use until it has been inspected by a Pro-Lift authorized service center. It is recommended that an annual inspection be done by qualified personnel. Labels and Operator's Manuals are available from manufacturer.

## PRODUCT DESCRIPTION

This Roller Chair Creeper Seat is equipped with a slidable chassis storage rack and two bottle racks for all of your car cleaning supplies, allowing you to easily clean the wheels without having to bend frequently to add pressure to the back and knees.

Rated Capacity: One person (includes any tools, equipment, personal items) weighing 300 lbs. or less.

## SPECIFICATIONS

Model	Rated Capacity	Seat Height	Creeper Length	Creeper Width	Net Weight	Gross Weight
C-9300	300 lbs.	13-1/4"	25-1/4"	12-3/4"	12 lbs.	13 lbs.

**⚠ WARNING:** Do not use this device for any purpose other than that for which it is expressly intended.



Figure 1 - Model C-9300 Components

# ⚠WARNING

- Read, understand, and follow all instructions before operating this device.
- Do not exceed rated capacity. Rated capacity is 300 lbs. (includes user, tools, equipment and personal items).
- Sit down gently. Avoid shock loads caused by jumping or falling onto seat.
- Do not stand on seat.
- Keep out of the reach of children! This device is not appropriate for children's use.
- Use on smooth, level surfaces only.

## PREPARATION

Before assembling your Roller Chair Creeper Seat, make sure all parts are present. If any part is missing or damaged, do not attempt to assemble or use the product. Contact Pro-Lift customer service for replacement parts.

## ASSEMBLY INSTRUCTIONS

1. Attach both tool trays (#1) to stool (#6)
2. Attach both wheel assembly frames (#2) to stool using (#3) screw and #4 washer, with (#4) washer and (#5) nut as shown in illustration.
3. Ensure all hardware is fastened securely before using this stool.

## MAINTENANCE

Little maintenance is required for this product. Wipe clean as needed.

- NEVER add lubricant to casters!
- Periodically check that all of the fasteners are tight.
- Keep the seat clean. Wash it with a mild soap and dry immediately.

## STORAGE

When you are finished using the stool, store it in a safe place where it will not disturb or hinder others.

## ASSEMBLY PARTS LIST

Item	Description	Qty
1	Tool Tray	2
2	Wheel assembly frame	2
3	M6 x 45 Screw	4
4	M6 washer	8
5	M6 flange nut	4
6	Stool	1

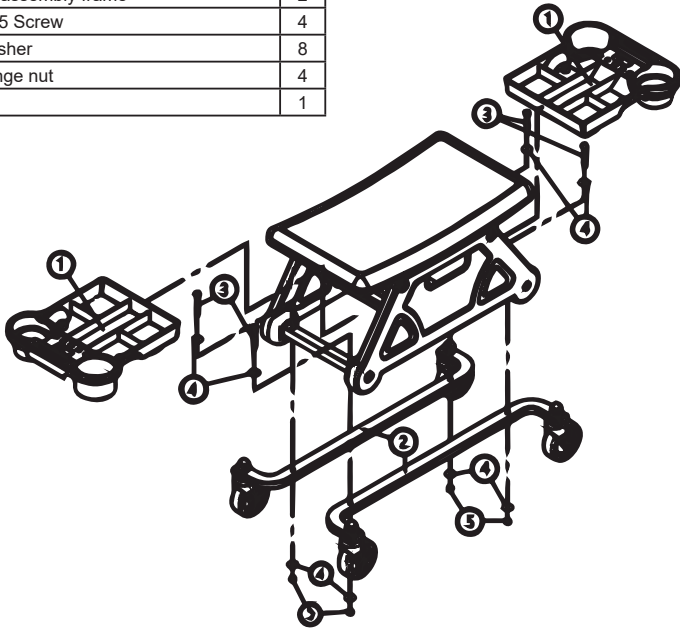

**REPLACEMENT PARTS LIST**

Item	Part No.	Description	Qty
1	C-9300-1	Tool Tray	1
2	C-9300-2	Wheel Assembly	2
3	-	M6 x 45 Screw	4
4	-	M6 washer	8
5	-	M6 flange nut	4
-	C-9300-3	Hardware Kit (contains #3 - 5)	1

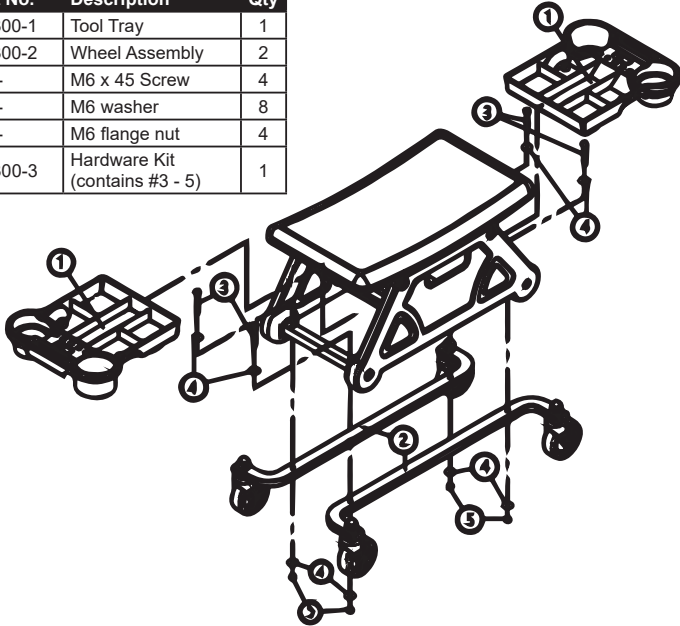

**ONE YEAR LIMITED WARRANTY**

For a period of one (1) years from date of purchase, **SFA Companies, Inc.** will repair or replace, at its option, without charge, any of its products, which fails due to a defect in material or workmanship under normal usage. This limited warranty is a consumer's exclusive remedy.

Performance of any obligation under this warranty may be obtained by returning the warranted product, freight prepaid, to **SFA Companies, Inc.**, Warranty Service Department, 10939 N. Pomona Ave., Kansas City, MO 64153.

Except where such limitations and exclusions are specifically prohibited by applicable law, (1) THE CONSUMER'S SOLE AND EXCLUSIVE REMEDY SHALL BE THE REPAIR OR REPLACEMENT OF DEFECTIVE PRODUCTS AS DESCRIBED ABOVE. (2) **SFA Companies, Inc.** SHALL NOT BE LIABLE FOR ANY CONSEQUENTIAL OR INCIDENTAL DAMAGE OR LOSS WHATSOEVER. (3) ANY IMPLIED WARRANTIES, INCLUDING WITHOUT LIMITATION THE IMPLIED WARRANTIES OF MERCHANTABILITY AND FITNESS FOR A PARTICULAR PURPOSE, SHALL BE LIMITED TO ONE YEAR, OTHERWISE THE REPAIR, REPLACEMENT OR REFUND AS PROVIDED UNDER THIS EXPRESS LIMITED WARRANTY IS THE EXCLUSIVE REMEDY OF THE CONSUMER, AND IS PROVIDED IN LIEU OF ALL OTHER WARRANTIES, EXPRESS OR IMPLIED. (4) ANY MODIFICATION, ALTERATION, ABUSE, UNAUTHORIZED SERVICE OR ORNAMENTAL DESIGN VOIDS THIS WARRANTY AND IS NOT COVERED BY THIS WARRANTY.

Some states do not allow limitations on how long an implied warranty lasts, so the above limitation may not apply to you. Some states do not allow the exclusion or limitation of incidental or consequential damages, so the above limitation or exclusion may not apply to you. This warranty gives you specific legal rights, and you may also have other rights, which vary from state to state.

**Pro-Lift**<sup>®</sup>

SFA Companies, Inc.  
10939 N. Pomona Ave.  
Kansas City, MO 64153  
Phone (816)891-6390, Fax (816)891-6599