

EFP - GEN Y - Marvel Spiderman 3012336

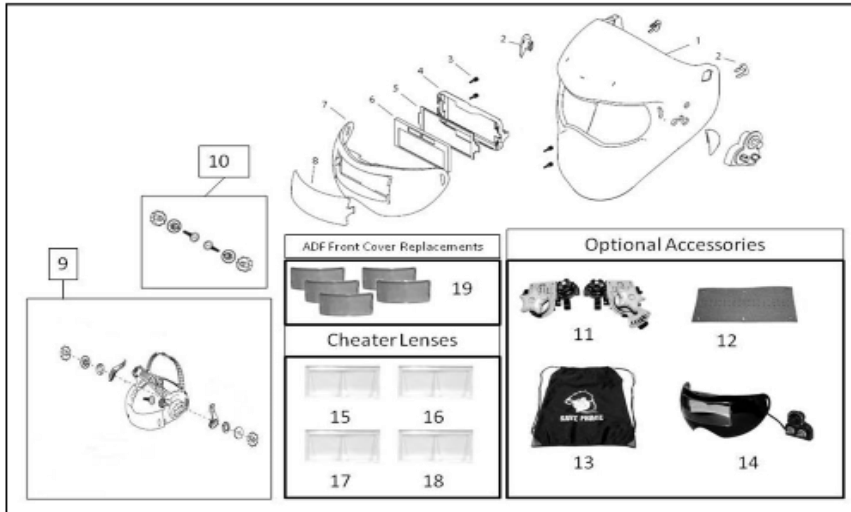

| Figure # | Part Number | Description  | No. Req'd |
|----------|-------------|--|-----------|
| 1        | N/A         | Hood   | 1         |
| 2        | 3010219     | Lens Key and Anchor, Left and Right  | 1         |
| 3        | 3010110     | ADF Screw  | 1         |
| 4        | 3010103     | ADF Back Cover   | 1         |
| 5        | 3010127     | BACK COVER 5PK GEN Y   | 1         |
| 6        | 3010936     | ADF LENS FOR S   | 1         |
| 7        | 3010080     | ADF HOLDER/PASSIVE LENS  | 1         |
| 8        | 3010097     | SP EFP ADF FRNT CVR REPL 1 PK  | 1         |
| 9        | 3011544     | HALO   | 1         |
| 10       | 3011551     | Halo KNOB SET  | 1         |
| 11       | 3011483     | Hard Hat Adapter (Optional accessory, not originally included with product)              | 1         |
| 12       | 3010196     | Replacement Halo Foam  | 1         |
| 13       | 3010226     | Replacement Protective Bag (Optional accessory, not originally included with product)    | 1         |
| 14       | 3010929     | EFP-Complete ADF Assembly - Gen Y  | 1         |
| 15       | 3010240     | Cheater Lens - Mag 1.0 (Optional accessory, not originally included with product)        | 1         |
| 16       | 3010257     | 1.5 CHEATER LENS (Optional accessory, not originally included with product)              | 1         |
| 17       | 3010264     | 2.0 CHEATER LENS (Optional accessory, not originally included with product)              | 1         |
| 18       | 3010271     | 2.5 CHEATER LENS (Optional accessory, not originally included with product)              | 1         |
| 19       | 3010691     | SP EFP ADP FRT COVER REPL 5PK (Optional accessory, not originally included with product) | 1         |

Notes From the date of the end user purchase, Save Phace will warranty or repair (At its option) it's products for one (1) year against defects in parts and workmanship. Any product of Save Phace that contains an ADF (Auto Darkening Filter) will carry a 24 month warranty on the ADF only and the remaining portion of the helmet will have a 12 month warranty protection against manufacturer defect. In the parts breakdown there are items that are listed as optional. These are additional accessories to the particular item that are not originally included with that item. These are considered a service part and carry a 90 day warranty from the date of the end user purchase. All other service parts carry a 90 day warranty as well if purchased individually with the exception of the ADF. The ADF will still carry a 24 month from the date of end user purchase warranty. To obtain warranty considerations please contact 1-888-332-6419, 1-888-332-6419 FREE or e-mail SavePhaceSupport@SFACompanies.com to obtain either an RMA or Service Part. Items should not be sent directly back without prior approval from manufacturer and an RMA issued from the manufacturer. In order to warranty a complete item an RMA must be made from the manufacturer, Not Matco, and provided to the distributor with instructions on how to proceed. A copy of the proof of purchase is required for all warranty considerations. For questions regarding warranty or warranty procedures please contact 1-888-332-6419, 1-888-332-6419 FREE.

|                         |                     |   |                                  |
|-------------------------|---------------------|---|----------------------------------|
| <b>Series</b>           | <b>Gen Y</b>        | <b>Switching Time at 23°C</b>               | 0.3ms                            |
| <b>Filter Dimension</b> | 4.25" x 2"          | <b>Sensitivity &amp; Delay Time Control</b> | YES                              |
| <b>View Size</b>        | 3.74" x 1.38"       | <b>Time From Dark to Light</b>              | 0.1-0.9s adjustable              |
| <b>Warranty</b>         | 24 months           | <b>Grinding Function</b>                    | YES                              |
| <b>Classification</b>   | 1/1/1/2             | <b>Grinding Warning Flash</b>               | NO                               |
| <b>Sensors</b>          | 2                   | <b>Low Battery Warning Indicator</b>        | NO                               |
| <b>Light State</b>      | 4                   | <b>Operation Temperature</b>                | -10°C- 65°C (14°F-149°F)         |
| <b>Dark State</b>       | Variable shade 9-13 | <b>Power Supply</b>                         | Solar Cell & Replaceable Battery |
| <b>Power Control</b>    | Fully automatic     | <b>Lowest Current Amp</b>                   | 5A                               |
| <b>Shade Control</b>    | YES, EXTERNAL       | <b>Interchangable Lenses</b>                | NO                               |
|                         |                     | <b>Cheater Lens Compatible</b>              | YES                              |